

# Exeter Township Zoning Permit Application

Exeter Township

Date: \_\_\_\_\_

Mail to: BHW Construction

1151 Route 315-Dolphin Plaza

Application #: \_\_\_\_\_

Plains, PA 18702

Fee: \$55.00 Payable to BHW Construction

570-270-3900

In accordance with the provisions of the Zoning Ordinance of Exeter Township, PA

of

Name \_\_\_\_\_

Address \_\_\_\_\_

Telephone #: \_\_\_\_\_

Hereby makes application for the issuance of a zoning permit for: \_\_\_\_\_

Located at: \_\_\_\_\_

(Give location, plan and lot number if applicable.)

The general shape of lot, and location and size of existing and proposed buildings being accurately shown on the plan on attached sheets which are made part of this application.

The lines of bounding roads and the property lines have been accurately located and staked on ground by (if surveyed): \_\_\_\_\_

Area of Lot:

Utilities

Area of existing buildings:

Water

Well

Area of proposed building:

Central

Height of structure:

Sewer

On Lot

Central

Gas

Electric

Present use of building and/or land: \_\_\_\_\_

Proposed use of building and/or land: \_\_\_\_\_

Preliminary inspection requested: \_\_\_\_\_

Completed cost of building: \_\_\_\_\_

(To include general contract, plumbing, heating, electrical, and labor)

Approved: \_\_\_\_\_

Permit #: \_\_\_\_\_

Not-Approved: \_\_\_\_\_

All necessary State, County and Township requirements have been met.

Owner's Signature \_\_\_\_\_

Agent's Signature \_\_\_\_\_

1. This page shall be used for the drawing of a site plan for all major construction and in all other cases as the Building Inspector deems necessary.
2. This site plan shall show the location and size of the lot, locations and sizes of the buildings structures upon the premises (both existing and proposed) and their relationship to adjoining premises and roads.
3. Locate and label clearly and distinctly all buildings and structures, show widths and depths of all yards, show namees of all roads and indicate north with a north arrow.
4. If the principal building or structure is to be served by an on site sewage disposal system a sketch of the system shall be shown.

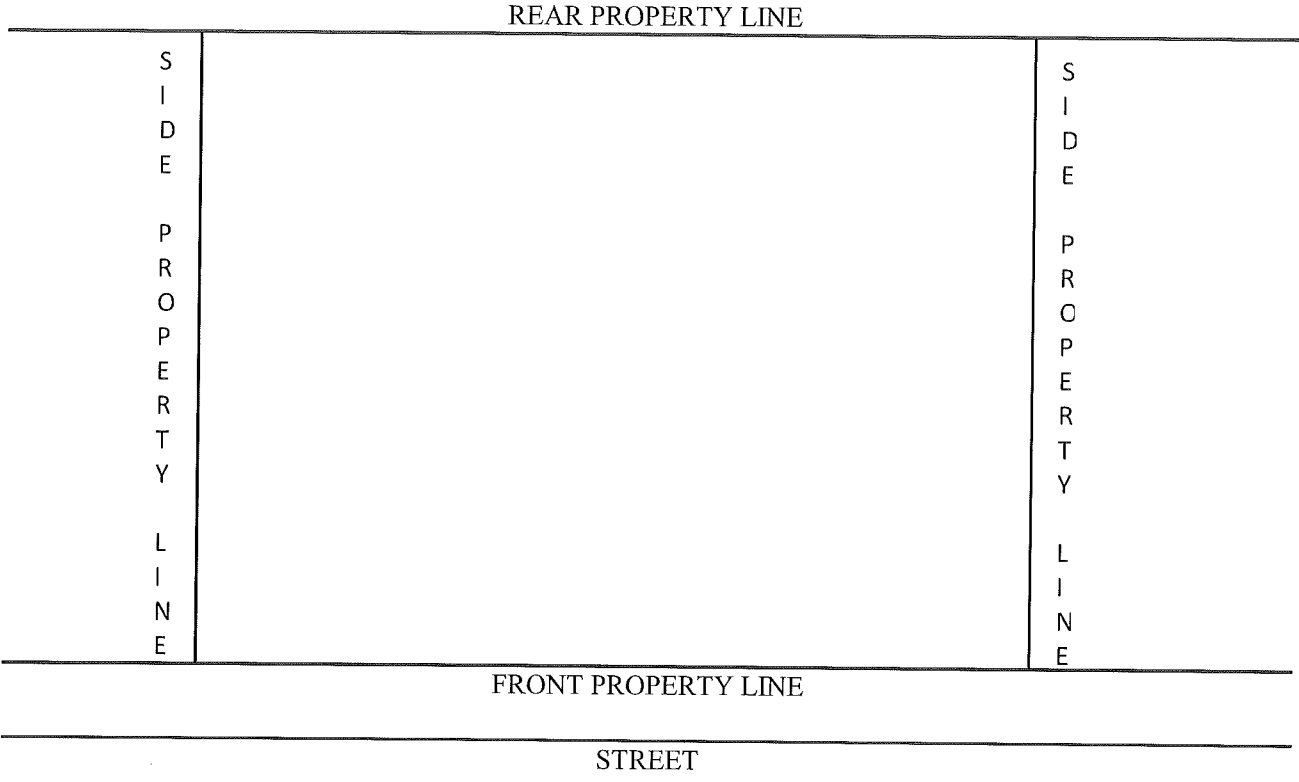

Locate all structures with a solid line.  
 Locate proposed structures with a broken line.

Description: \_\_\_\_\_  
 \_\_\_\_\_  
 \_\_\_\_\_  
 \_\_\_\_\_

**\*\*A copy of the property owner's deed is required to be submitted with this application\*\***